

CLICK ON HAZARD LOCATION FOR CONTACT INFORMATION.

ADDITIONAL INFORMATION IS AVAILABLE THROUGH THE MSU BIOSAFETY OFFICER AT (406) 994-6998

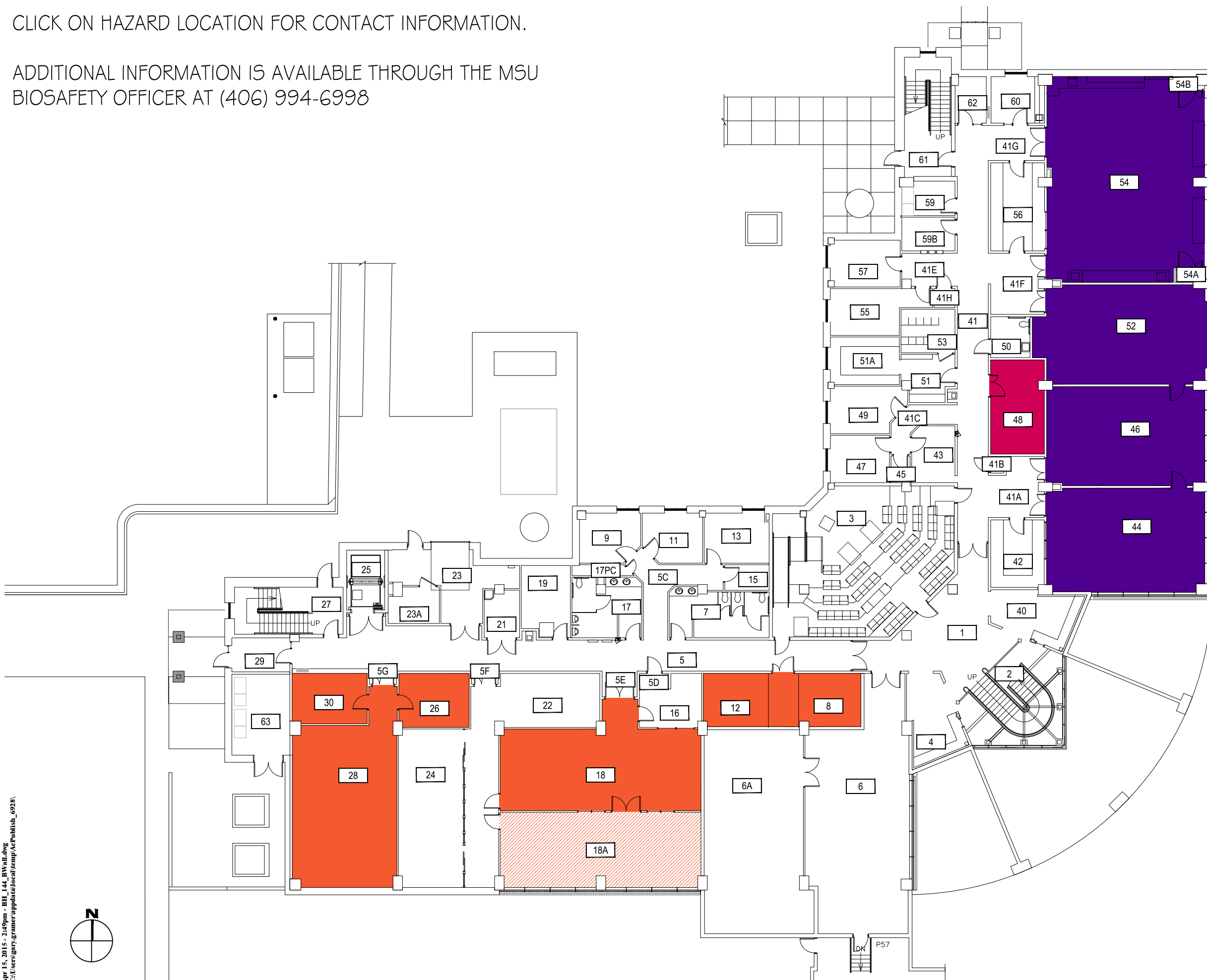

Chemical



CHEMICAL

Radiation



RADIATION

1



BIOHAZARD

2



BIOHAZARD

3



BIOHAZARD

Indicates access only through hazard area.

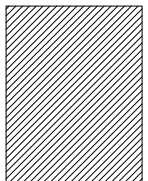

CHEMISTRY BIOCHEMISTRY BLDG

LEVEL B

CAMPUS PLANNING,
DESIGN & CONSTRUCTION
MONTANA STATE UNIVERSITY
BOZEMAN, MONTANA
PHONE: 406.994.5413 FAX: 406.994.5665

SHEET TITLE

SHEET
LB

DATE
01-06-15

0 10' 20' 40'



SCALE: 1" = 20'

Apr 15, 2015 - 2:34pm - BH_144_BW.rvt.dwg
C:\Users\gary.gramer\appdata\local\temp\AcPublish_6928\

CLICK ON HAZARD LOCATION FOR CONTACT INFORMATION.

ADDITIONAL INFORMATION IS AVAILABLE THROUGH THE MSU BIOSAFETY OFFICER AT (406) 994-6998

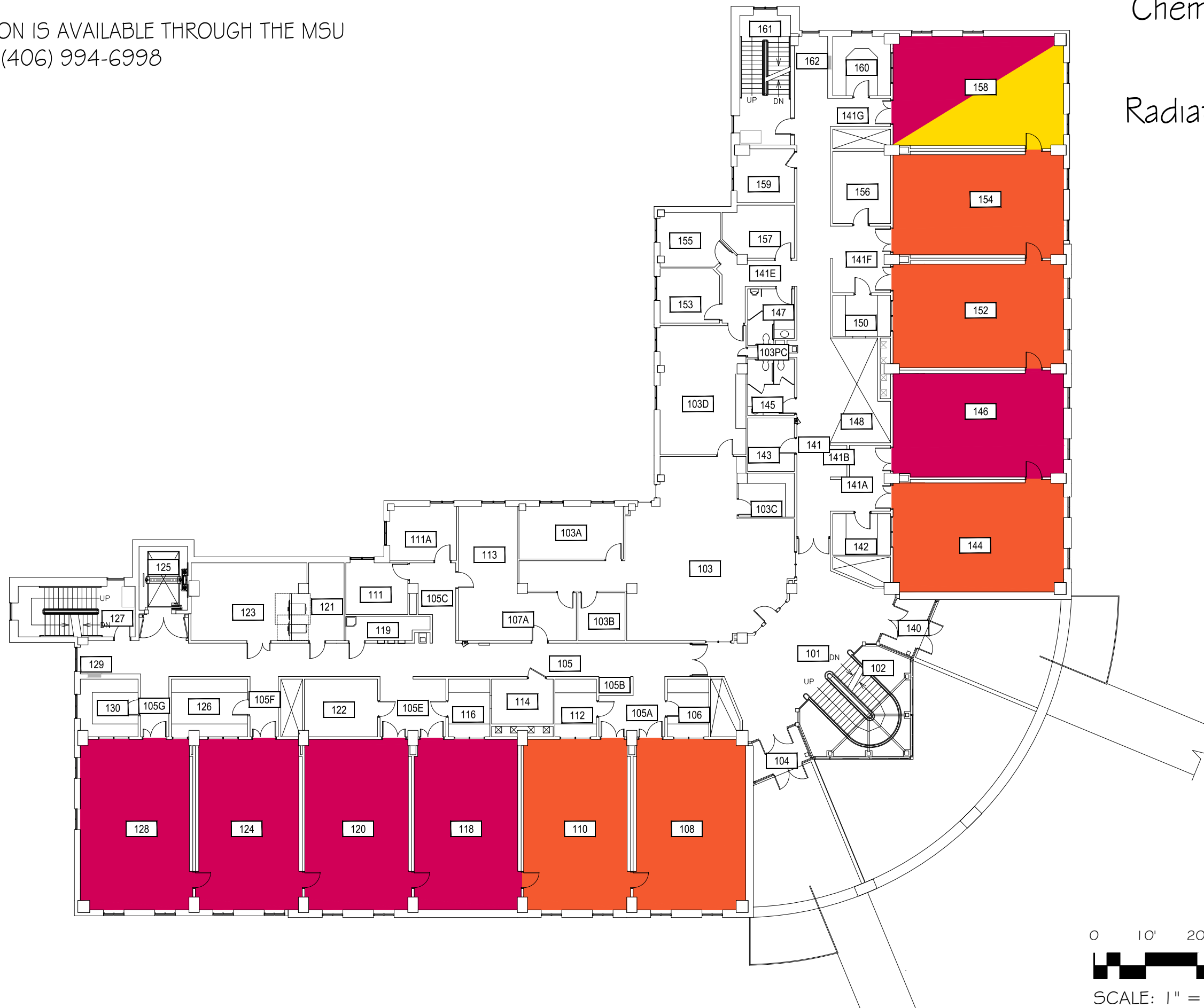

Chemical



Radiation



1



2



3



Indicates access only through hazard area.

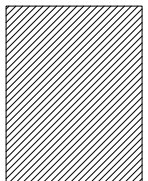

0 10' 20' 40'



SCALE: 1" = 20'

Apr 15, 2015 - 2:49pm - BH_144_1W.dwg
E:\Log - Feasibility\13-06-06\13-06-06 Biohazard Areas\130 Drawings\Chemistry Biochemistry\



CHEMISTRY BIOCHEMISTRY BLDG

LEVEL 1

CAMPUS PLANNING,
DESIGN & CONSTRUCTION
MONTANA STATE UNIVERSITY
100 N. UNIVERSITY AVENUE
BOZEMAN, MONTANA 59717
PHONE: 406.994.5413 FAX: 406.994.5665

SHEET TITLE

SHEET

11

DATE
01-06-15

CLICK ON HAZARD LOCATION FOR CONTACT INFORMATION.

ADDITIONAL INFORMATION IS AVAILABLE THROUGH THE MSU BIOSAFETY OFFICER AT (406) 994-6998

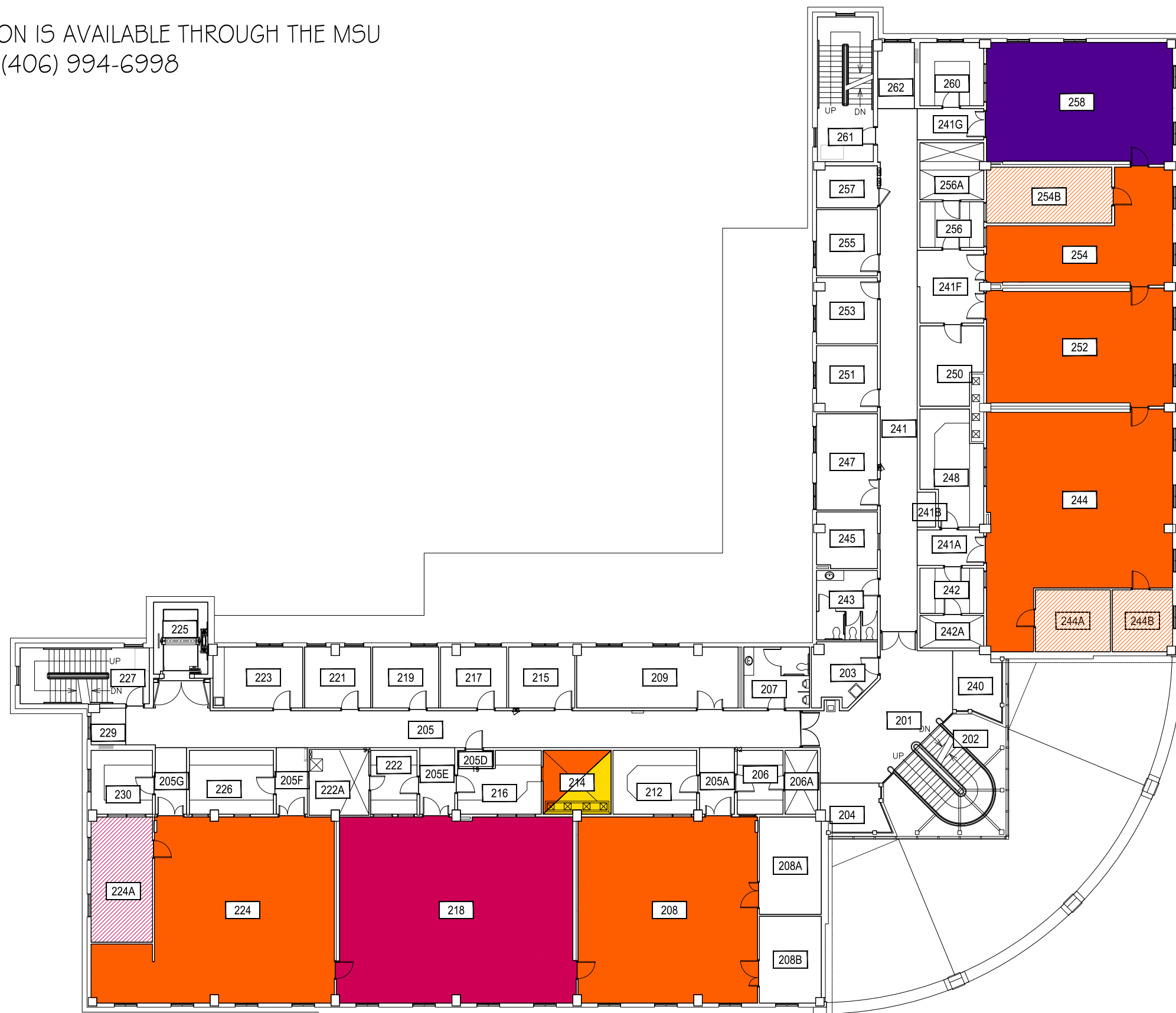

Chemical



Radiation



1



2



3



Indicates access only through hazard area.

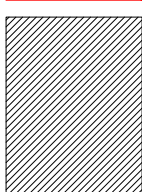

CHEMISTRY BIOCHEMISTRY BLDG

LEVEL 2

CAMPUS PLANNING,
DESIGN & CONSTRUCTION
MONTANA STATE UNIVERSITY
100 N. UNIVERSITY AVENUE
BOZEMAN, MONTANA 59717
PHONE: 406.994.5413 FAX: 406.994.5665

SHEET TITLE

SHEET
L2

DATE
01-06-15

0 10' 20' 40'



SCALE: 1" = 20'



Apr 15, 2015 - 3:09pm - BH_144_2Wall.dwg
C:\Users\gary.gramer\appdata\local\temp\AcPublish_6928\

CLICK ON HAZARD LOCATION FOR CONTACT INFORMATION.

ADDITIONAL INFORMATION IS AVAILABLE THROUGH THE MSU BIOSAFETY OFFICER AT (406) 994-6998

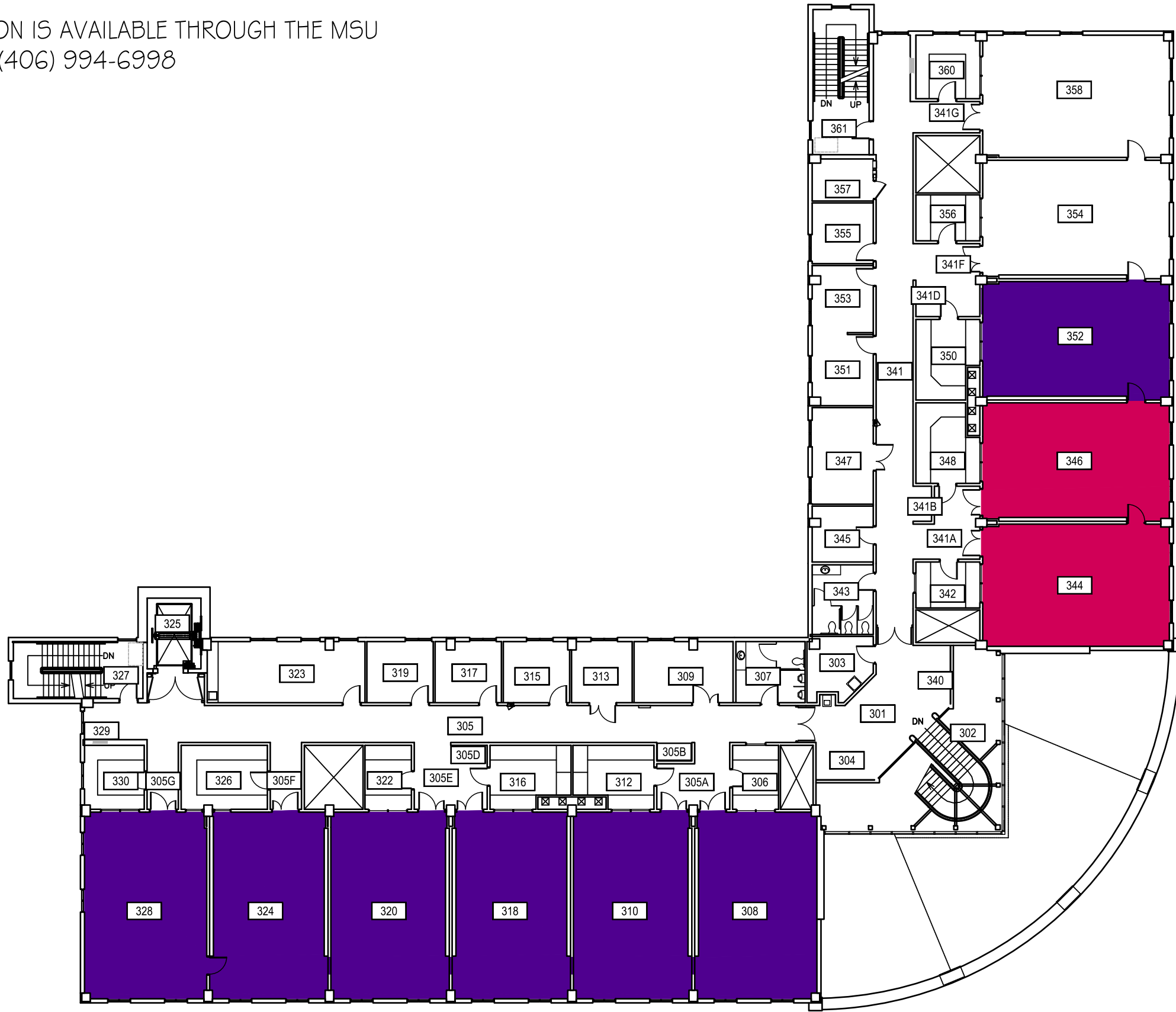

Chemical



CHEMICAL

Radiation



RADIATION

1



BIOHAZARD

2



BIOHAZARD

3



BIOHAZARD

Indicates access only through hazard area.

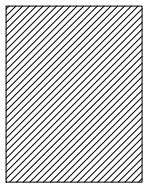

0 10' 20' 40'



SCALE: 1" = 20'