

CLICK ON HAZARD LOCATION FOR CONTACT INFORMATION.

ADDITIONAL INFORMATION IS AVAILABLE THROUGH THE MSU BIOSAFETY OFFICER AT (406) 994-6998



# PLANT BIOSCIENCE BLDG

LEVEL 1

CAMPUS PLANNING,  
DESIGN & CONSTRUCTION  
MONTANA STATE UNIVERSITY  
PHONE: 406.994.5413 FAX: 406.994.5665

SHEET TITLE

SHEET  
**L1**

DATE  
01-06-15

Chemical



Radiation



1



2



3



Indicates access only through hazard area.

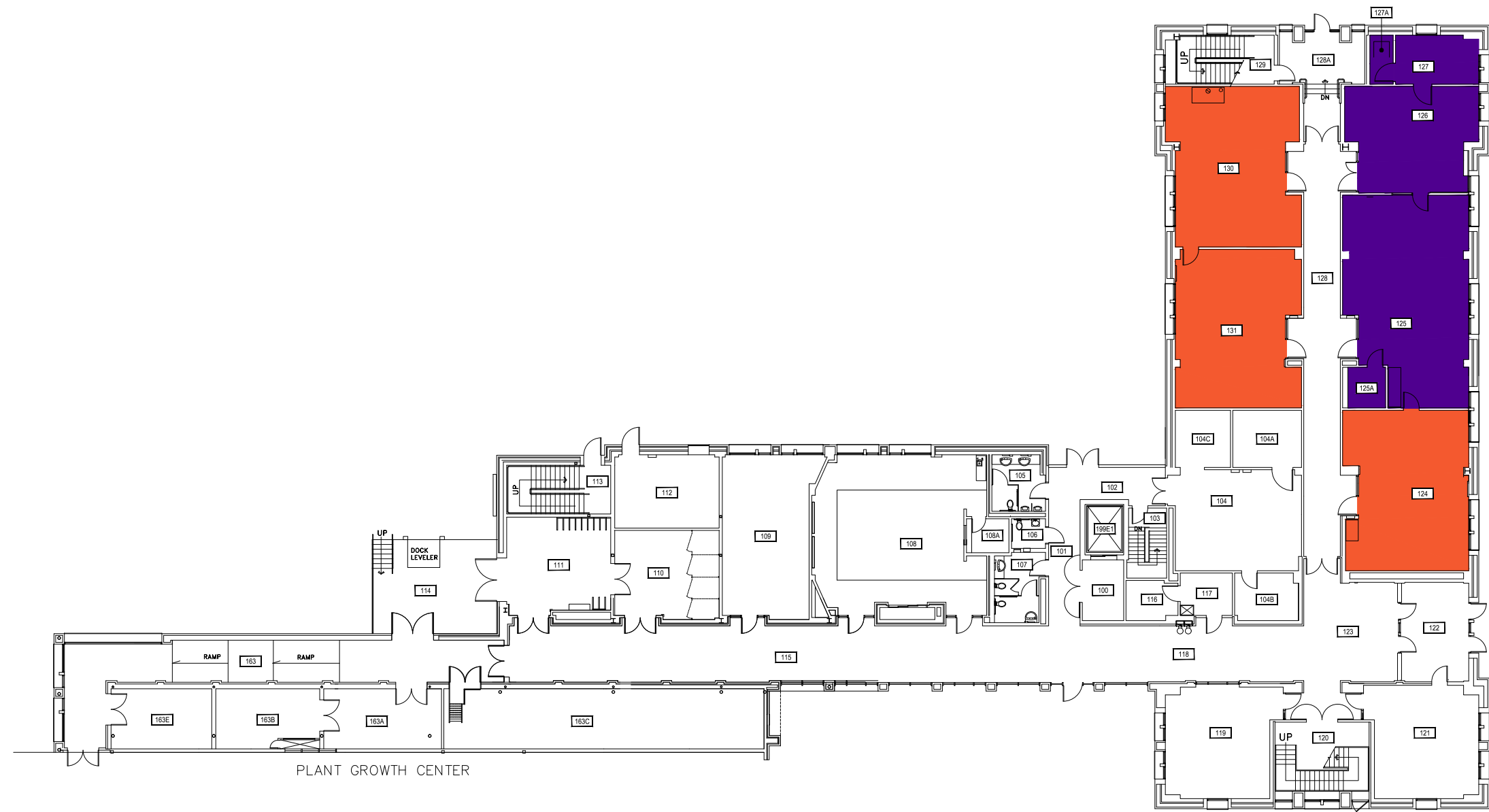
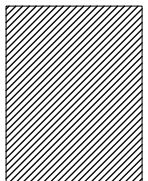

0 12'-6" 25' 50'



SCALE: 1" = 25'

Apr 15, 2015 - 1:15pm - BH\_400\_1W\_all.dwg  
E:\Log - Feasibility\13-00-00\13-06-06 Biohazard Areas\130 Drawings\Plant Bioscience Building

CLICK ON HAZARD LOCATION FOR CONTACT INFORMATION.

ADDITIONAL INFORMATION IS AVAILABLE THROUGH THE MSU BIOSAFETY OFFICER AT (406) 994-6998

Apr 15, 2015 - 1:39pm - BH\_400\_21Wall.dwg  
C:\Users\gary.gramer\appdata\local\temp\AcPublish\_6928\



Chemical



CHEMICAL

Radiation



RADIATION

1



BIOHAZARD

2



BIOHAZARD

3



BIOHAZARD

Indicates access only through hazard area.

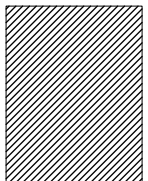

# PLANT BIOSCIENCE BLDG

LEVEL 2

CAMPUS PLANNING,  
DESIGN & CONSTRUCTION  
MONTANA STATE UNIVERSITY  
100 N. UNIVERSITY AVENUE  
BOZEMAN, MONTANA 59717  
PHONE: 406.994.5413 FAX: 406.994.5665

SHEET TITLE

SHEET  
**L2**

DATE  
**01-06-15**

0 10' 20' 40'



SCALE: 1" = 20'

